

**POT BEARING HOUSING ASSEMBLIES
FOR VOLKMANN MANUAL & AIR THREADED POTS
06, BA1, BA2, AND BA3
REBUILD & EXCHANGE SERVICE**

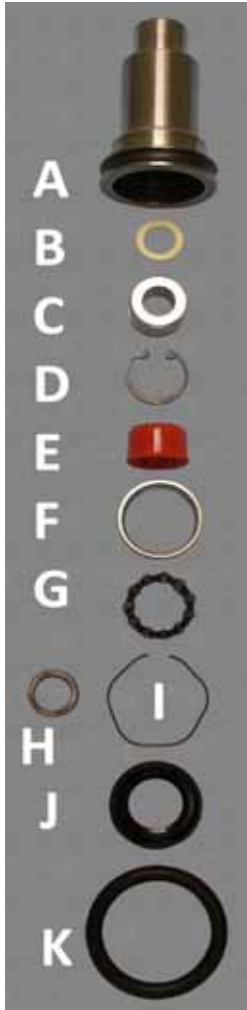

REBUILDING POT BEARING HOUSINGS: The used assembly is disassembled, cleaned and inspected. Epic **always** replaces the felt sealing washer (B), upper needle bearing (C), nylon spacer bushing (E), lower outer race (F), bearing cage (G), and wire retaining ring (I). Any static parts that show wear or faults are also replaced. The rebuilt assembly is lubricated with Kluber synthetic grease.

The rebuilt pot bearing housings function “like new”, at a significant savings to the customer.

Because it is good practice to replace the inner race (H) on the upper spindle blade when replacing the lower outer race (F) and cage, polyamide (G), a new inner race (H) is also supplied with the exchange or rebuilt assembly.

- (A) EE480741: Outer Steel Shell
- (B) EE480740: Top Felt Washer
- (C) EE401994-2: Needle Bearing Set
- (D) EE434324: Internal Retaining Ring
- (E) EE401914: Nylon Spacer Bushing
- (F) EE401909: Outer Race
- (G) EE401910-1: Bearing Cage, Polyamide
- (H) EE401911: Inner Race
- (I) EE401913: Wire Retaining Ring
- (J) EE401912: Labyrinth Ring
- (K) EE435036: O-Ring (Damping Protection)

OEM #	Epic #	Description
VTS-06, B1-BA3		
070793 908731	EE440024	Complete NEW Pot Bearing Housing, with inner race
(070793) (908731)	EE402029	REBUILD Customer's Complete Pot Bearing Housing
	EE402029-1	USED & REBUILT Complete Pot Bearing Housing, for Exchange (when available)
	EE402029-2	REBUILT FOR SALE, Complete Pot Bearing Housing (when available)
062514	EE489037	Tool, Grease Packing Nipple for Pot Bearing Housing

Revised June 29,2011

Epic Enterprises, Inc., PO Box 979, Southern Pines, NC 28388-0979 USA
Telephone 800-648-7273 or 910-692-5441 Outside USA
Fax 888-692-4147 or 910-692-4147 Outside USA
Website: <http://www.epicenterprises.com>
E-mail: epic@epicenterprises.com

